

AIS-ADVDH0ML-011

AD Board with VGA/DVI/HDMI input, LVDS Output



AIS-ADVDH0ML-011

Full HD LCD Scalar Controller Board

The AIS-ADVDH0ML-011 is a highly integrated TFT flat panel interface board that allows connecting analog 15Pin RGB, DVI 1.0 and HDMI 1.4 source with TFT panels and the USB media input.

Key Features

- Up to 1920 x 1200 input / Up to 1920 x 1200 panels
- HDMI 1.4, DVI 1.0, USB media player
- LVDS panel connection @60Hz
- I2C, RS232/485 commands & control
- On board backlight LED driver
- USB Firmware upgrade

Panel Connectivity

LVDS (Dual Channel)	up to 1920 x 1200 @60Hz
Panel Resolutions:	1920 x 1200, 1920 x 1080
Customization:	Support customize resolution i.e. 1280 x 320

Input

HDMI 1.3	60Hz up to 1920 x 1080
VGA	60Hz up to 1920 x 1200 75Hz up to 1400 x 1050 75Hz up to 1440 x 900

Reliability

Operating Temp:	-10~50°C
Storage Temp:	-20°C~60°C
Operating Humidity:	0% ~ 80% (non-condensing)
Storage Humidity:	0% ~ 90%
Warranty:	1 years

Features

Colors:	Up to 8 bits per color, i.e. 16.7 million colors
Function Display:	On Screen Display (OSD) menu
Function Control:	External buttons, Serial Port
Image Control:	Brightness, Contrast, Sharpness, Gamma, Color mode, Color temperature
Image Scaling:	Up / Down scaling to fit input to panel resolution
Other Features:	Dynamic system menu to fill the screen, Frame buffer for FRC image enhancement, Transparent OSD
Communication:	RS-232/RS485(Optional)
Input Power:	12VDC ±5%, 15W
Panel Power:	Supports 3.3V, 5V, 12V panels
Panel Signal:	Single/Dual channel 10 bit LVDS
Backlight Driver:	Backlight on/off, PWM
Plug & Play:	DDC 1,2/b compatible
Status Indicator:	Dual color LED support
Audio:	Digital Audio line-out

Custom Splash-Screen: The AIS-ADV0HPML-001 supports custom splash- screen when powering on. This requires custom firmware.

Firmware Upgrade: The firmware version can be upgraded directly from a PC running Windows. Contact us for more detail



Datasheet

AIS-ADVDH0ML-001

AD Board with VGA/DVI/HDMI input, LVDS Output

Mechanical Drawing

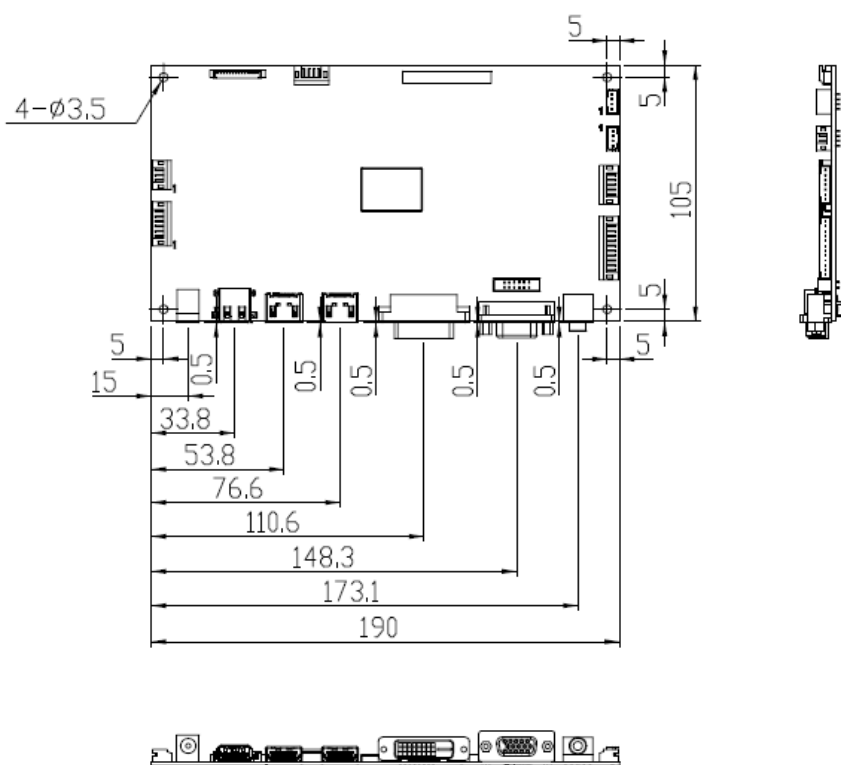

Connector Definitions

- CON1 DC Jack/2.5mm +12Vdc Input
- J1 8PIN/2.0mm +12Vdc Input & BKL Control
- J2 5PIN/2.0mm +5VSTB Input & Power Module On/Off Control
- J3 Box Header 12PIN/2.0mm VGA Signal In
- J4 6PIN/2.0mm RS232 & RS485 Control
- J5 Wafer 12PIN/2.0mm Video Board Input
- J7 14PIN/1.25mm KEY PAD & IR
- J8 4PIN/2.0mm Audio_AMP_Right Output
- J9 4PIN/2.0mm Audio_AMP_Left Output
- J10 6PIN/2.0mm Panel Power Selection
- J11 41PIN/0.5mm LVDS Signal Interface

Ordering Options

AIS-ADVDH0ML-011	P/N: AIS-ADVDH0ML-011
OSD Key-pad 5-key	P/N: AIS-ADKP005-001
Cable Keypad 5-key 75mm	P/N: AIS-CAK0750-001
IR remote controller	
Backlight driving board	[subject to panel model]
Sensor kit	

Available Resource

- 2D (PDF)
- 3D (SLDPRT)
- Product approval sheet
- Custom engineering: Splash screen, OSD menu, coating, & more...

** Available on request



The QR code above links to the product page on the website



Advanced Input Systems Taiwan

No. 237, 10F-1, Da-Tong Road Section 1, Xi-Zhi District New Taipei City, 22161 Taiwan

Web Site: <http://www.aistaiwan.com>

Tel: +886-2-7729-1391

Fax: +886-2-7729-1392